

PARTS BINS

AVAILABLE IN 9" AND 12" DEEP MODELS

Durham Bins are a proven solution to parts storage needs. Dividers and raised bin fronts create secure, accessible compartments that are easy to restock and pick from. Ideal for storing and organizing fasteners and other parts.

All bins have 20 welds per shelf, providing superior strength and assuring longer life

Durable gray powder coating is rust and corrosion resistant

360° turn. Roll formed uprights provide increased strength compared to conventional hemmed uprights

Prime cold rolled steel will not warp, twist or sag

Fully hemmed 1-1/8" high bin fronts/label holders retain parts.

Open compartments allow for easy access of parts

Ribbed and hemmed dividers provide added strength



MODEL 363-95
72 Bins shown on Optional Base
MODEL 364-95

MODULAR

Parts Bins have mounting holes in tops and bottoms for secure stacking. This permits the stacking of the same or varying configured bins or other dimensionally compatible Durham storage units.



MODEL 654-95
See pages 22- 23 for other modular systems



MODEL 351-95
20 Bins



MODEL 330-95
12 Bins



MODEL 329-95
4 Bins

PRESSURE SENSITIVE BIN LABELS

*See page 6 for model numbers & ordering information.

Preprinted or blank labels make it easy to identify bin contents. Available in the following, easy to clean sets of most common size fasteners:

CAP SCREW SETS

USS or SAE. 6 pages each printed black on heavy coated yellow paper.

METRIC SETS

9 pages printed black on heavy white paper.

STAINLESS STEEL SET

4 pages. Black on heavy coated silver paper.

MISCELLANEOUS SETS

6 pages including carriage bolts, plow bolts, stove bolts, nuts, washers, cotter pins and sheet metal screws. Black on heavy coated yellow paper.

BLANK LABELS

10 pages, 36 labels per page. Available in white or yellow.



12" DEEP PARTS BINS & ACCESSORIES

Full piano hinges assure tight fit and prevent doors from sagging

Padlock attachment for security. (Padlock not included).

Base is easy to assemble with fasteners provided



Durable gray powder coating is rust and corrosion resistant

OPTIONAL HINGED DOOR SETS

Doors turn Parts Bins into secure storage units and protect parts from dust and pilferage. Shipped separately, doors attach using sheet metal screws or pop rivets.

OPTIONAL BASES



MODEL 364-95

12" DEEP BIN BASE

Fits all 12" x 33-3/4" Parts Bins. Easily assembled with fasteners provided. Sturdy 12" deep base raises Bins 5-3/4" above floor surface. All steel construction.



MODEL 352-95

8 bins

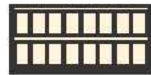

MODEL 353-95

16 bins

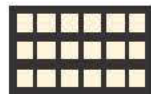

MODEL 354-95

18 bins

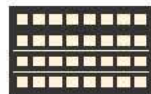

MODEL 357-95

32 bins

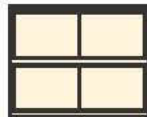

MODEL 329-95

4 bins

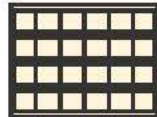

MODEL 356-95

24 bins

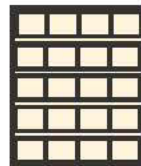

MODEL 351-95

20 bins



MODEL 361-95

56 bins

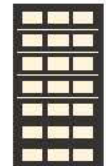

MODEL 355-95

21 bins

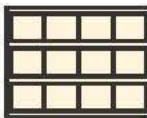

MODEL 330-95

12 bins

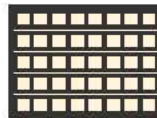

MODEL 359-95

40 bins

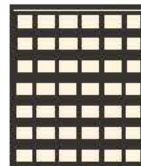

MODEL 360-95

42 bins

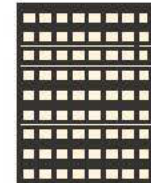

MODEL 363-95

72 bins



MODEL 358-95

36 bins

12" DEEP PARTS BINS

| Model | Dim: WxDxH | No. Bins | Bin Dimensions: WxDxH | Ship Wt. | Carton Pk. |
|--------|-------------------------|----------|----------------------------|----------|------------|
| 329-95 | 33-3/4" x 12" x 23-7/8" | 4 | 16-3/4"x 11-7/8" x 11-7/8" | 40 lbs.* | 1 |
| 330-95 | 33-3/4" x 12" x 23-7/8" | 12 | 8" x 11-7/8" x 6-5/8" | 36 lbs.* | 1 |
| 352-95 | 33-3/4" x 12" x 5-1/4" | 8 | 4" x 11-7/8" x 5-1/4" | 15 lbs.* | 1 |
| 353-95 | 33-3/4" x 12" x 11-1/2" | 16 | 4" x 11-7/8" x 5-1/8" | 25 lbs.* | 1 |
| 354-95 | 33-3/4" x 12" x 19-1/4" | 18 | 5-3/8" x 11-7/8" x 6-3/8" | 38 lbs.* | 1 |
| 351-95 | 33-3/4" x 12" x 42" | 20 | 8" x 11-7/8" x 8-1/2" | 55 lbs. | 1 |
| 355-95 | 17-7/8" x 12" x 42" | 21 | 5-3/8" x 11-7/8" x 5-3/8" | 37 lbs.* | 1 |
| 356-95 | 33-3/4" x 12" x 23-7/8" | 24 | 5-3/8" x 11-7/8" x 5-1/2" | 44 lbs.* | 1 |
| 357-95 | 33-3/4" x 12" x 19-1/4" | 32 | 4" x 11-7/8" x 4-1/2" | 41 lbs.* | 1 |
| 358-95 | 17-7/8" x 12" x 42" | 36 | 4" x 11-7/8" x 4-1/2" | 50 lbs.* | 1 |
| 359-95 | 33-3/4" x 12" x 23-7/8" | 40 | 4" x 11-7/8" x 4-1/2" | 50 lbs.* | 1 |
| 360-95 | 33-3/4" x 12" x 42" | 42 | 5-3/8" x 11-7/8" x 5-1/2" | 71 lbs. | 1 |
| 361-95 | 33-3/4" x 12" x 42" | 56 | 4-7/8" x 11-7/8" x 5-1/8" | 75 lbs. | 1 |
| 363-95 | 33-3/4" x 12" x 42" | 72 | 4" x 11-7/8" x 4-1/2" | 80 lbs. | 1 |

| Model | Dim: WxDxH | Fits Models | Ship Wt. | Carton Pk. |
|-----------------------------------|----------------------------|--|----------|------------|
| <i>Optional Hinged Door Sets</i> | | | | |
| 365-95 | 33-3/4" x 42" | 360, 361, 363, 351 | 18 lbs.* | 1 set |
| 366-95 | 33-3/4" x 23-7/8" | 356, 359, 329, 330 | 11 lbs.* | 1 set |
| <i>Optional 12" Deep Bin Base</i> | | | | |
| 364-95 | 33-3/4" x 12-1/4" x 5-3/4" | 329, 330, 351, 352, 353, 354, 356, 357, 359, 360, 361, 363 | 13 lbs.* | 1 |

All units ship FOB CT



*Ships UPS